

Wheel Features

Tread Material:	TPR	Core Material:	High Strength PP
Bearing:	Single Ball Bearing	Tread Hardness:	80A±3
Temperature:	-15°C~60°C	Running Speed:	3.2km/h

Note: Use beyond temperature range or beyond the recommended speed may shorten product life or even damage the product.



- ✔ Precision ball bearing, flexible rotation
- ✔ Advanced thermo-plastic rubber, silent running, elastic to protect floor
- ✔ Environmental protection, quiet, effectively protect the floor
- ⚠ Economical material with common load capacity



Rolling resistance	■ ■ ■ □ □	Good
Wear resistance	■ ■ ■ □ □	Good
Operating noise	■ ■ ■ ■ ■	Excellent
Floor surface preservation	■ ■ ■ ■ ■	Excellent

Bracket Features

- ✔ Easy to operate, convenient to release the brake
- ✔ Spindle equipped with precision bearing, quiet and flexible
- ✔ Nylon-injection core, lightweight and tough
- ✔ Galvanized, salt spray test over 48 hours
- ✔ This product has passed TUV certification. Utility model patent owned, protected by intellectual property law.

Parameter (mm)							
Wheel Size	Capacity	Wheel Dia.	Wheel Width	Total Height	Offset	Swivel Radius	Swivel Radius
3"	30 kg	75	25	114	24	61.5	84
4"	80 kg	100	32	152	32	82	112

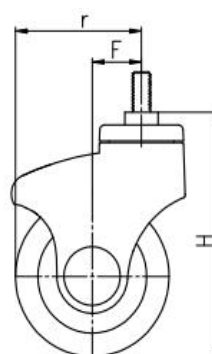
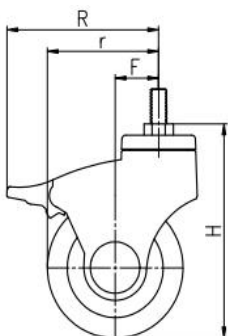

[English]

Mounting Drawing

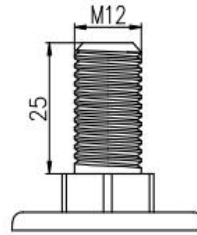
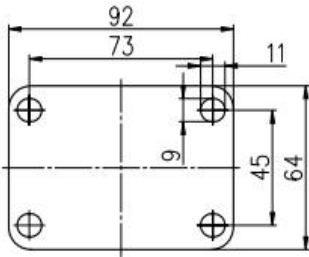

Product ID				
Product Images				
Wheel Size	Plate swivel	Plate fixed	Threaded stem	Threaded stem brake
4"	80N01-1698	80N02-1698	80N10-1698	80N11-1698
5"	80N04-1594	80N05-1594	80N13-1594	80N14-1594

Product Details



Embedded cover, anti-winding, and effectively protect the bearing

Nylon bracket is Integrated injection molding with high strength.



Optimized brake pedal angle, easy to operate

