

Wheel Features

Tread Material:	Rubber	Core Material:	High Strength PP
Bearing:	Ball Bearing	Tread Hardness:	72A±3
Temperature:	-20°C~50°C	Running Speed:	4km/h

Note: Use beyond temperature range or beyond the recommended speed may shorten product life or even damage the product.



- ✔ 2 precision ball bearings,flexible rotation
- ✔ Natural rubber material,combined with harder rubber core,high rebound
- ✔ Environmental protection,quiet,effectively protect the floor
- ✔ With metal covers,thread-proof design



Rolling resistance	■ ■ ■ □ □	Good
Wear resistance	■ ■ ■ ■ □	Very good
Operating noise	■ ■ ■ ■ ■	Excellent
Floor surface preservation	■ ■ ■ ■ ■	Excellent

Bracket Features

- ✔ Steel plate pressed and welded,firm and strong
- ✔ Dustproof ring effectively protects grease for long sevice life
- ✔ Environmentally friendly colour galvanized,salt spray test over 48 hours

Parameter (mm)	Capacity	Wheel Dia.	Wheel Width	Total Height	Offset	Swivel Radius
Wheel Size	Capacity	Wheel Dia.	Wheel Width	Total Height	Offset	Swivel Radius
6"	150 kg	150	55	190	44	119
8"	200 kg	200	63	250	50	150
10"	250 kg	250	63	305	60	185

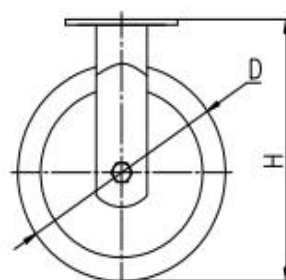
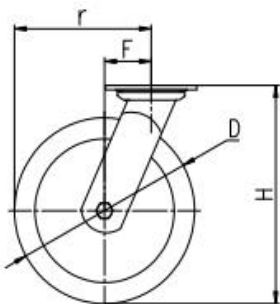

Mounting Drawing

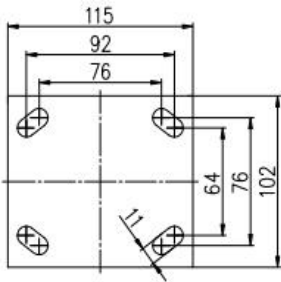

Product ID

Product Images



Wheel Size

Plate swivel

Plate fixed

6"

65B01-1502

65B02-1502

8"

65B06-1503

65B07-1503

10"

65B11-1504

65B12-1504

Product Details



Reinforced wheel core with higher strength.

Large eaves of wheel hub can ensure the locking strength of wheel surface and wheel core.



Dust ring can effectively protect grease lubrication, avoid dust and other impurities in harsh environment.

